



The Homes of Hunters Ridge

A Condominium Community



The Homes of Hunters Ridge provide easy carefree condominium living at it's finest! Take advantage of the lock and leave lifestyle with professional lawn care and snow removal. Zero step entries, extra wide hallways & first floor laundry makes every condominium we build comfortable with barrier free accessibility!

INTERIOR FEATURES

- 1518 Sq. Ft.
- 2 Bed/2 Bath with 2 Car Garage
- Luxury Vinyl Plank Floor
- Central Air
- Cathedral Ceiling & Ceiling Fans
- Maple Cabinetry
- Kitchen Pantry Closet
- Dishwasher
- Ice Maker Line
- Garbage Disposal
- Microwave Rang Hood
- Great Room w/ Gas Fireplace
- Plant Shelves w/Switched Outlet
- Skip Trowel Drywall Finish
- 200 Amp Electrical Service
- 40 Gallon Water Heater
- Window Returns w/ Water Resistant Cultured Marble Sills
- Basement Rough in for Future Bath & Egress Window

EXTERIOR FEATURES

- Private Patio (additional paver patio permitted)
- No Maintenance Vinyl Siding
- All Aluminum Soffit and Fascia
- Aluminum Gutters & Downspouts
- Foundation Insulation
- No Maintenance Vinyl Windows
- Professionally Landscaped
- Egress Window Well in Basement
- Asphalt Driveway and Road
- Maintenance Free Aluminum Clad Garage and Front Door Jambs

ENERGY SAVING FEATURES

- 2 x 6 Exterior Home Walls
- High Efficiency Furnace
- High Efficiency Water Heater
- Low E Insulated Windows
- Insulated Garage Door with Opener
- Drywall Finished and Insulated Garage

Condos for Sale

Scan Here

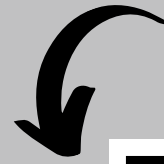

www.midwestrents.com

ADDRESS	PRICE	AVAILABILITY
3240 Elk Ridge Dr	\$339,900	SOLD!
3242 Elk Ridge Dr	\$339,900	SOLD!
3244 Elk Ridge Dr	\$339,900	Under Contract
3246 Elk Ridge Dr	\$339,900	April 1
3236 Elk Ridge Dr	\$339,900	June 1

Layout

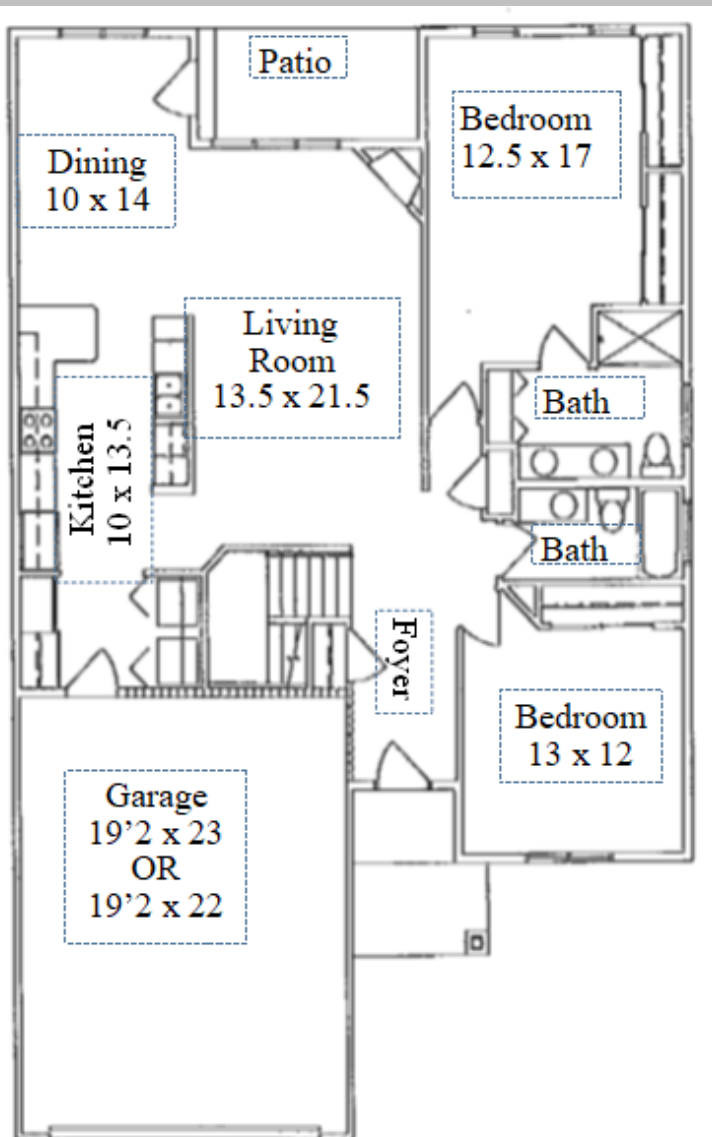

Location is key!

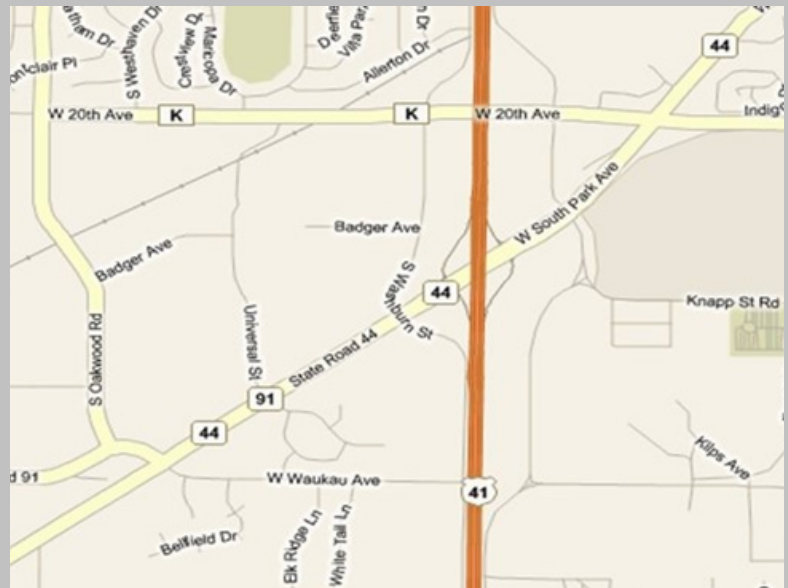

The Homes of Hunters Ridge are conveniently located just minutes from Grocery Stores, Shopping, Restaurants, Hospitals/Clinics, AND easy access to the Highway!



All Dimensions, Features, Elevations, Floor Plans, Options & Prices are approximate & may be reversed or changed without notice